



Installation Instructions
Single, Double, Triple, Quadruple Station
SloanStone
Solid Surface Installation Instructions

ELGR-80000 Series

One/Two/Three/Four Station Solid Surface Lavatory Systems



ELGR-81000
Gradient Deck™ Sink Lavatory
System SloanStone Solid Surface



ELGR-82000
Gradient Deck™ Sink Lavatory
System SloanStone Solid Surface



ELGR-83000
Gradient Deck™ Sink Lavatory
System SloanStone Solid Surface

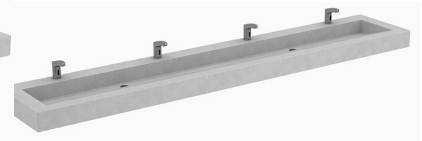

ELGR-84000
Gradient Deck™ Sink Lavatory
System SloanStone Solid Surface



IMPORTANT



Read this entire installation manual to ensure proper installation. When finished with the installation, file this manual with the owner or maintenance department. Compliance and conformity to local codes and ordinances is the responsibility of the installers.



Separate parts from packaging and make sure all parts are accounted for before discarding any packaging material. If any parts are missing, do not begin installation until you obtain the missing parts.



Make sure that all water supply lines have been flushed and then completely turned off before beginning installation. Debris in supply lines can cause valves to malfunction.
Turn OFF electrical power to the electrical outlets, then unplug all



electrical units prior to installation. Electrical power MUST remain off until installation is complete.



Installer's hardware must be appropriate for wall construction. Wall anchors must have a minimum pull-out rating of 1,000 lbs.



For standard height mounting, do not exceed the recommended 34" distance from the top of the lav deck to the finished floor. To meet ADA requirements, the lav deck cannot exceed the 34" maximum height dimension.

PRIOR TO INSTALLATION

Important:

- Prior to installing the lavatory system, install the items listed below. Also refer to the appropriate rough-in diagram.
- **ADEQUATE STRUTURAL SUPPORT IN OR BEHIND THE WALL IS REQUIRED.**

- **ALL PLUMBING SHOULD BE INSTALLED IN ACCORDANCE WITH APPLICABLE CODES AND REGULATIONS..**
- **BEFORE CONNECTING FLEX HOSES TO SUPPLY STOPS, FLUSH ALL WATER LINES UNTIL WATER IS CLEAR.**

LIMITED WARRANTY

Unless otherwise noted, Sloan Valve Company warrants its Products to be made of first class materials, free from defects of material or workmanship under normal use and to perform the service for which they are intended in a thoroughly reliable and efficient manner when properly installed and serviced, for a period of three years (1 year for SF Faucets, special finishes and PWT electronics and 30 days on PWT software) from date of purchase. During this period, Sloan Valve Company will, at its option, repair or replace any part or parts which prove to be thus defective if returned to Sloan Valve Company, at customer's cost, and this shall be the sole remedy available under this warranty. No claims will be allowed for labor, transportation or other incidental costs. This warranty extends only to persons or organizations who purchase Sloan Valve Company's products directly from Sloan Valve Company for purpose of resale. This warranty does not cover the life of the batteries.

THERE ARE NO WARRANTIES WHICH EXTEND BEYOND THE DESCRIPTION ON THE FACE HEREOF. IN NO EVENT IS SLOAN VALVE COMPANY RESPONSIBLE FOR ANY CONSEQUENTIAL DAMAGES OF ANY MEASURE WHATSOEVER.

LAVATORY SYSTEM ROUGH-IN DIMENSIONS SINGLE STATION

ELGR-81000

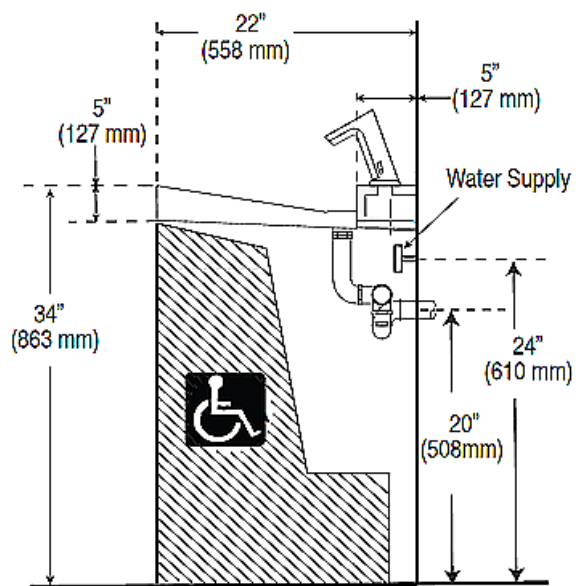
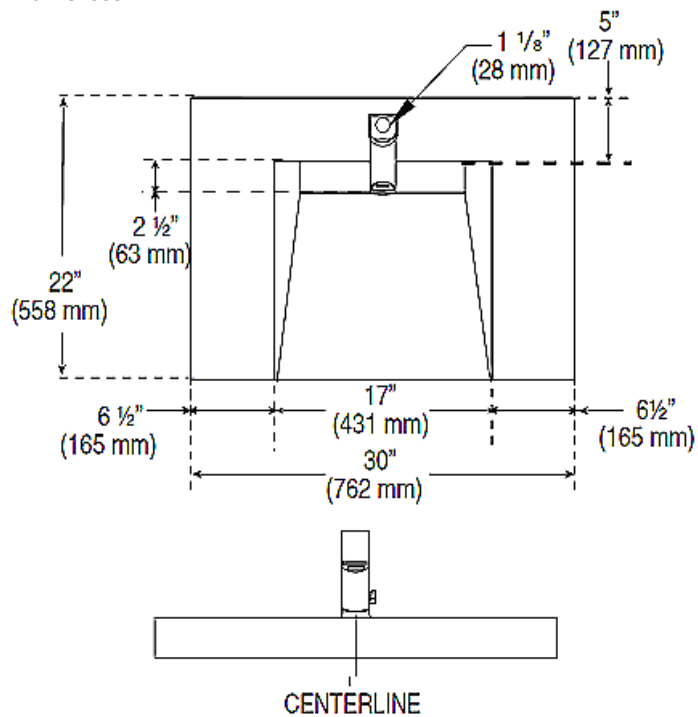

LAVATORY SYSTEM ROUGH-IN DIMENSIONS TWO STATION

ELGR-82000

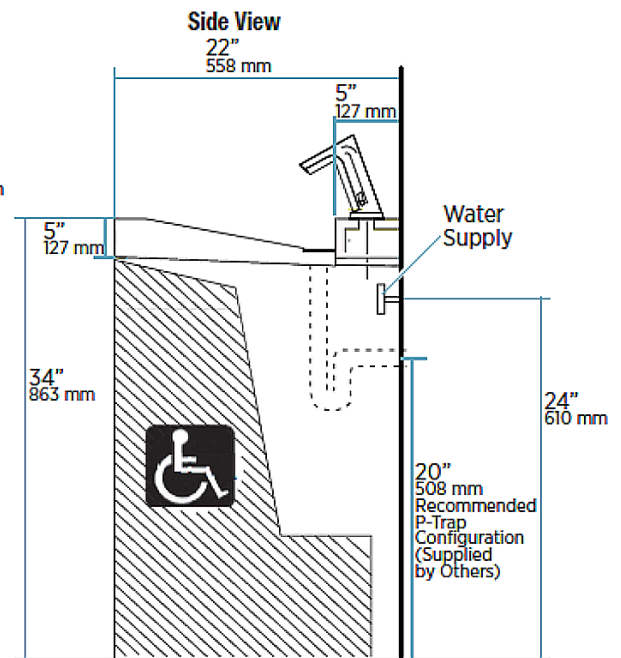
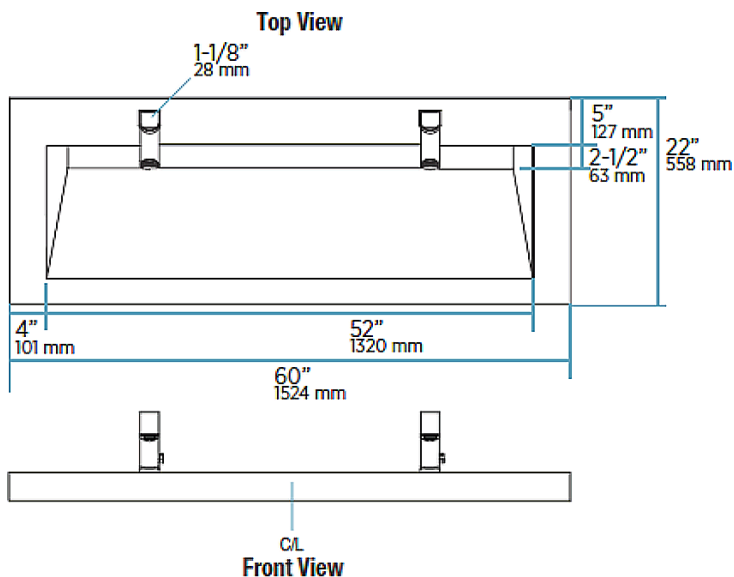

LAVATORY SYSTEM ROUGH-IN DIMENSIONS THREE STATION

ELGR-83000

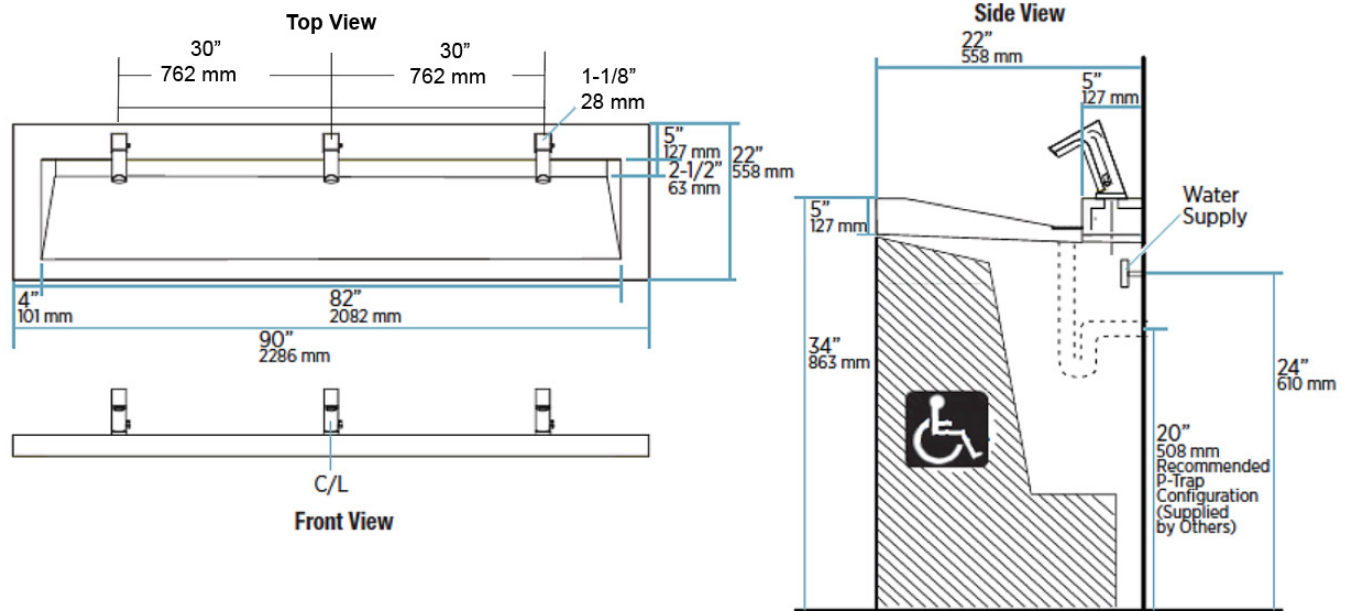

LAVATORY SYSTEM ROUGH-IN DIMENSIONS FOUR STATION

ELGR-84000

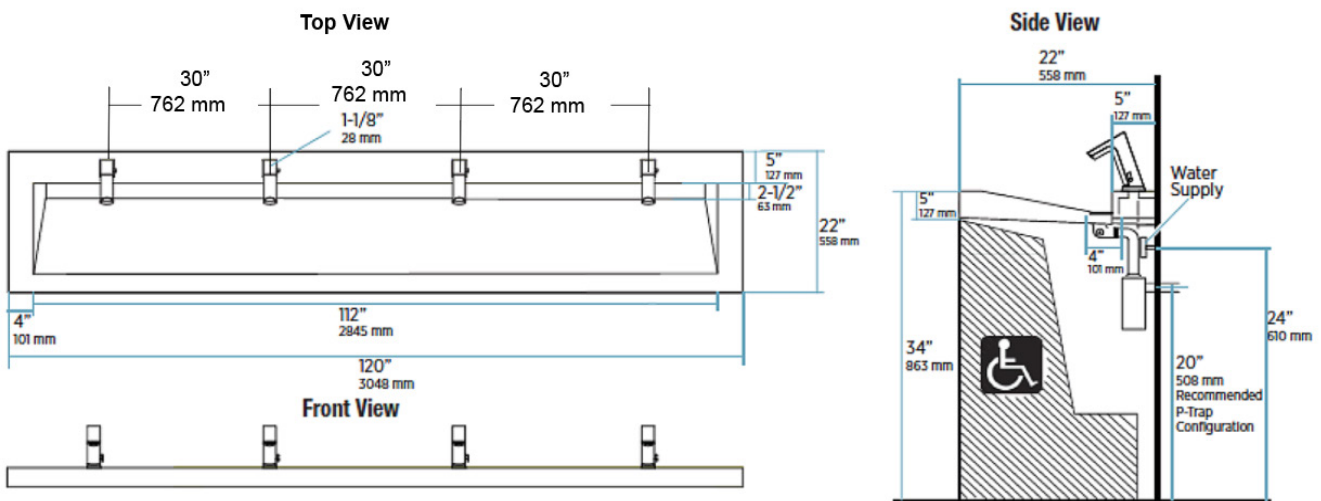

TOOLS REQUIRED FOR INSTALLATION

- Electric drill for drilling anchor holes.
- Socket or open end wrench for installing anchoring fasteners.
- Adhesive Caulk for vanity or bracket mounting
- Adhesive for Lavatory optional mounting
- Open end wrench for connecting water lines.
- Pipe wrench for installing drain lines.

SINK LOCATION

Determine the appropriate wall location for the Lavatory System. Consider that hot and cold water supply lines, a drain line, and an electrical source (receptacle for hardwired faucets) will be required. Compare the physical dimensions of the Lavatory System to the space available for the installation. If wall is not load bearing, a carrier may be required behind the wall. Refer to the appropriate Rough-in diagram on pages 2 – 3 for Lavatory System dimensions. Prior to Lavatory System installation, electric wiring, water supply and drain must be installed.

1- STRAINER INSTALLATION

- Insert Strainer into Basin using plumbers putty (supplied by installer).
- From beneath Basin, install the Rubber Gasket, Cardboard Seat and Drain Nut onto Strainer. Secure Drain Nut against Basin.

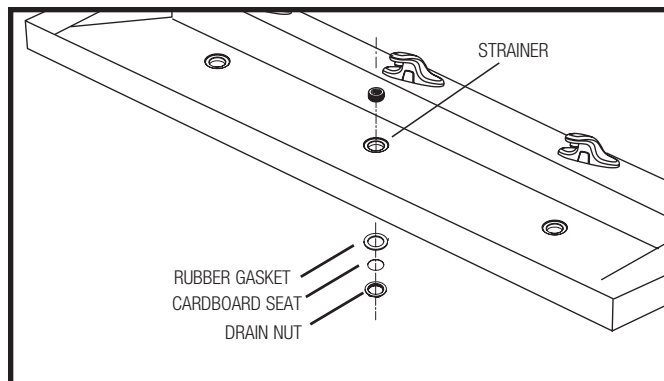

2- INSTALL FAUCET, SENSOR, DRAIN AND WATER LINE CONNECTIONS

- Install faucet, sensor, and water line connections as instructed in the installation instructions furnished with the Faucet.
- Flush supply line(s) of any debris. Install Flex Hose(s) to water supply line(s). Tighten fitting(s) securely.

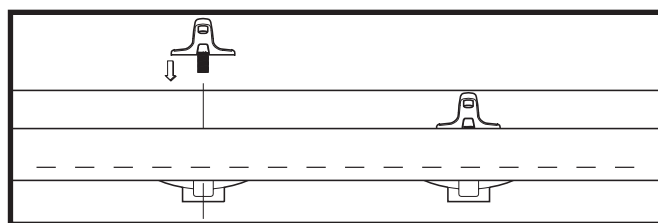

- Install P-trap and drain lines making sure that all connections are secure.

Note: P-trap and drain lines furnished by others.

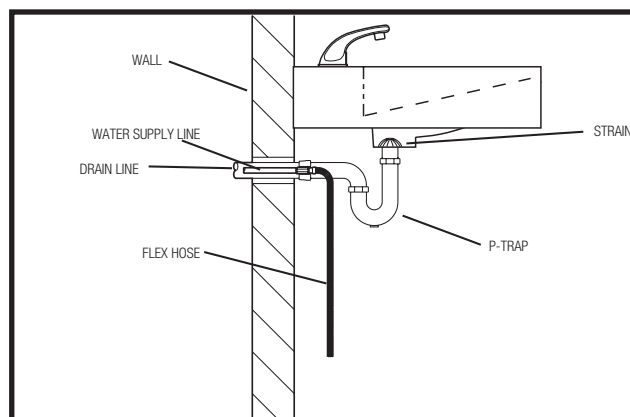

CARE AND CLEANING

DO NOT USE abrasive or chemical cleaners (including chlorine bleach) to clean lavatory deck or faucets that may dull the luster and attack the finish. Use ONLY soap and water, then wipe dry with clean cloth or towel.

While cleaning the sink area, protect the faucet from any splattering of cleaner. Acids and cleaning fluids will discolor or remove chrome plating.

PARTS LIST

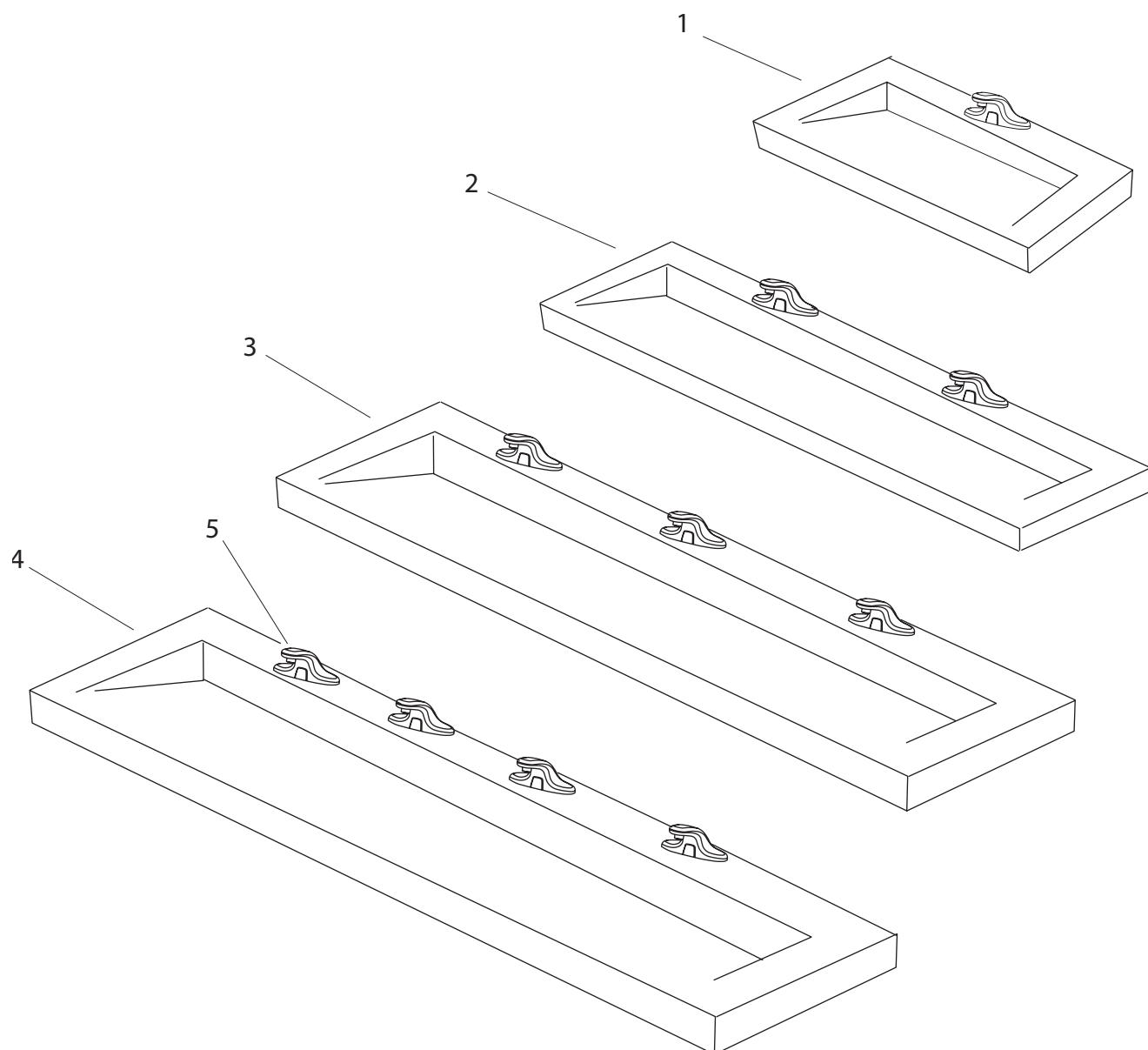

Item No.	Description
1	ELGR-81000 Deck (single)
2	ELGR-82000 Deck (double)
3	ELGR-83000 Deck (triple)
4	ELGR-84000 Deck (Quadruple)
5	Sloan Faucet (model varies)
6	Grid Strainer Assembly (not Shown)

NOTICE:

The information contained in this document is subject to change without notice.

SLOAN • 10500 SEYMOUR AVENUE • FRANKLIN PARK, IL 60131

Phone: 1-800-9-VALVE-9 or 1-847-671-4300 • Fax: 1-800-447-8329 or 1-847-671-4380 • www.sloan.com

COPYRIGHT © 2016 SLOAN VALVE COMPANY

Code No. 0816699 – Rev. 1 (11/16)