

CNA Shown with
Deluxe Cart

Installation

Keltech® Portable Carts

For use with certain:

C1N Series - Light Industrial Heaters

C2N Series - Light Industrial Heaters

CNA Series - Large Industrial Heaters

Table of Contents

Safety Information	2
Dimensions	3
Pre-Installation Information	4
Storage Instructions	4
Mounting Heater to Cart	4
Heater Setup and Startup	5
Cart Options	6-7

WARNING

Tipover hazard. System can crush you resulting in serious injury or death. Read and follow precautions in this installation manual that accompanied the heater for instructions on how to safely transport and anchor heater. Always use caution while transporting heater.

Read this manual BEFORE using this equipment. Failure to read and follow all safety and user information could result in death, serious personal injury, minor burns, property damage, or damage to the equipment. Keep this Manual for future reference. Failure to comply with proper installation and maintenance instructions could contribute to the heater's failure.

A qualified plumber or electrician should install and service this system. Install system according to these instructions and the instructions shipped with the heater as well as in compliance with national and local codes.

ASSE standard 1016, 1069 or 1070 listed devices should be used at fixtures to prevent possible injury. Severe bodily injury including scalding, chilling, and/or death may result depending upon system water pressure changes and/or supply water temperature changes.

For safe operation of the heater, observe all warning labels as indicated.

Water heater system under pressure. Do not open enclosure while in operation.

These heaters should never be used to provide "anti-scald" or "anti-chill" service.

Hazardous voltage inside enclosure may result in serious burns or death. Disconnect power supply before performing any work in the enclosure.

Failure to ground this system may result in death or serious injury.

Make sure that all water supply lines have been flushed and then completely turned off before beginning installation. Debris in supply lines can cause valves to malfunction.

CAUTION

Hot pipes! Do not touch. May cause minor burns.

NOTICE

These heaters do not provide protection from supply or outlet pipe freezing.

Consult local building and plumbing codes prior to installation. Should these codes differ from the information in the Manual, follow the local codes. Inquire with governing authorities for additional local requirements.

Regular checking and cleaning of the heater's internal components and check stops is necessary for maximum life and proper product function. Periodic inspection and yearly maintenance by a licensed contractor is required. Corrosive water conditions, and/or unauthorized adjustments or repairs could render the heater ineffective for its intended service. Frequency of cleaning and inspection depends upon local water conditions. For heaters with adjustable output temperatures, check and adjust as needed at initial installation and on a quarterly basis.

IMPORTANT

Read this entire installation manual to ensure proper installation. When finished with the installation, file this manual with the owner or maintenance department. Compliance and conformity to local codes and ordinances is the responsibility of the installer. Product warranties may be found under "Products" on our Web site at www.keltech-inc.com.

Separate parts from packaging and make sure all parts are accounted for before discarding any packaging material. If any parts are missing, do not begin installation until you obtain the missing parts.

Dimensions

Portable C1N and C2N Series with Deluxe Cart



*Dimensions for deluxe cart shown.
Standard cart dimensions are identical.*

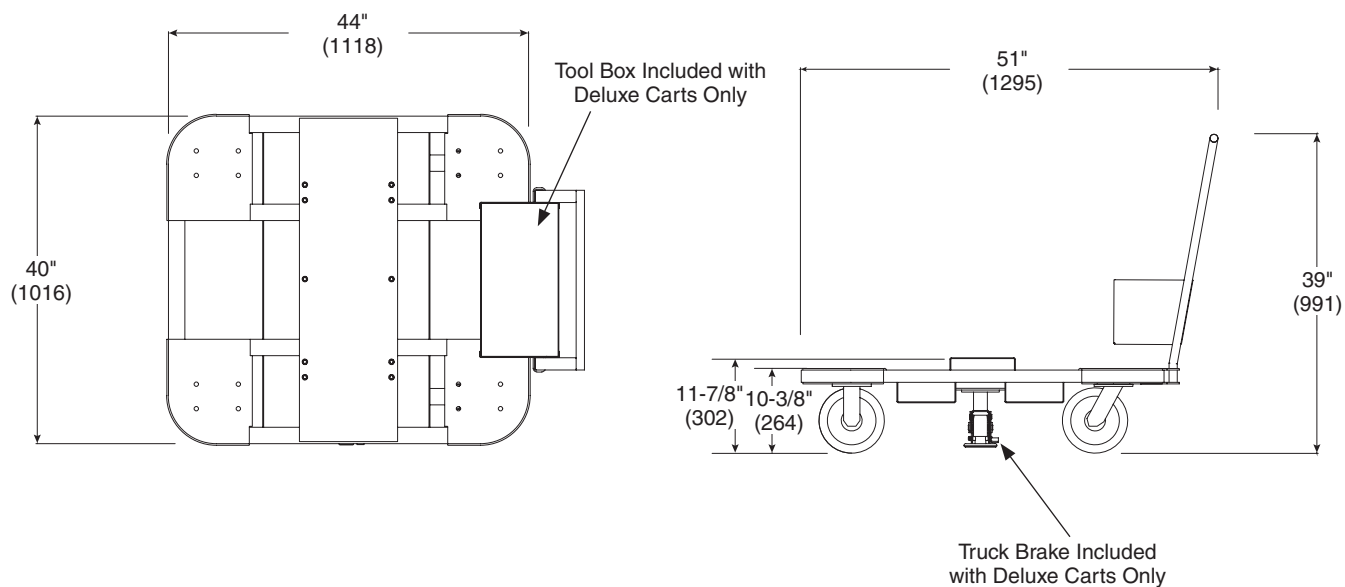

Portable CNA Series with Deluxe Cart

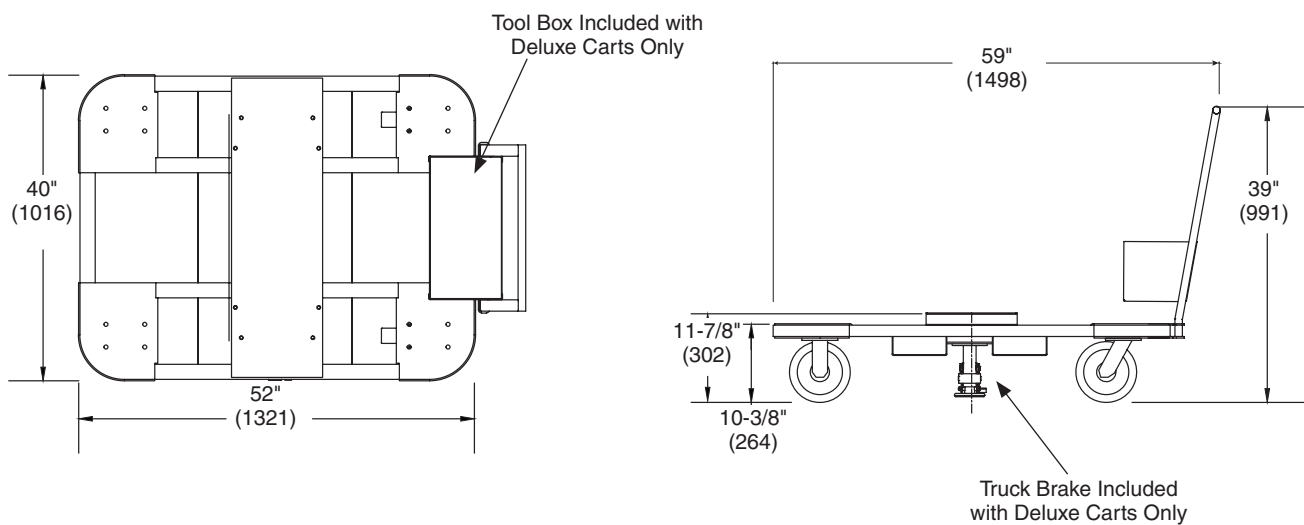

Pre-Installation Information

General Information

The Keltech Portable Tankless Water Heater Solutions includes heavy-duty carts for moving the heater safely and efficiently to the point of use for instant and precise temperature-controlled hot water. To ensure proper performance, install the heater to the cart utilizing these instructions and following the installation instructions included with the Keltech Electric Tankless Water Heater model shipped with the cart. Ensure compliance with applicable national and local codes.

Storage Instructions

NOTICE! Keep Keltech Portable Carts stored in original packaging until installation.

Recommended storage criteria:

Store Keltech Products where temperatures exceed 35°F (2°C) at all times.

Indoor storage is required.

1 Mounting Heater to Cart

A

Utilize a team lift, fork truck or overhead crane to set heater in a vertical, upright position on the cart. Be sure the Heater door is facing away from the cart push handle and the water outlet is located at the top.

B

With the heater door open, align holes in bottom of heater enclosure with mounting holes in top side of pedestal on cart.

C

Secure heater to pedestal using 3/8" (10mm) anchor bolts (8 places for CNA, 6 places for C1N and C2N).

NOTICE! Always fill heater with water before turning on power to the heater to prevent damage to heating elements.

CNA Heater shown.
C1N and C2N are similar.

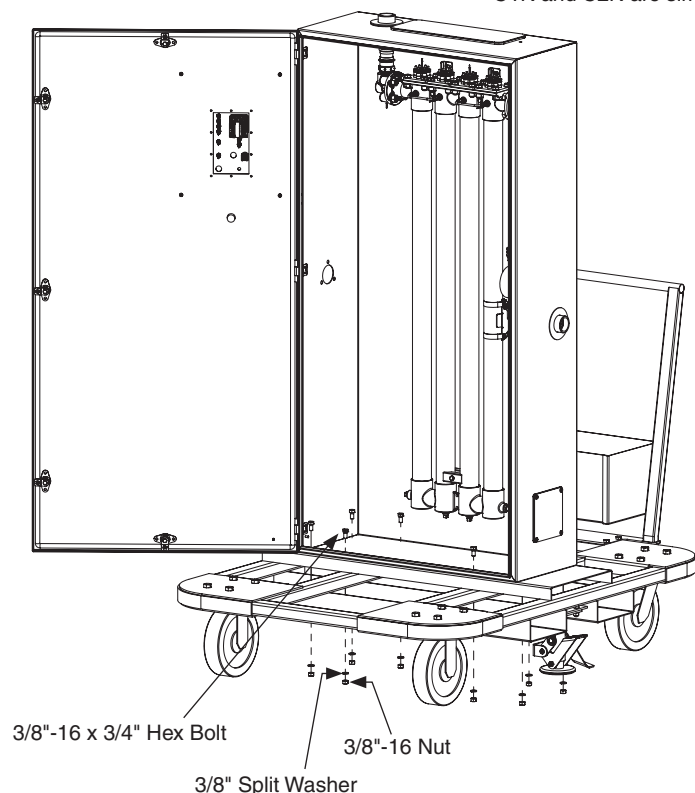

2 Heater Setup and Startup

A

Refer to the included Keltech Electric Tankless Water Heater installation manual for all instructions related to plumbing, electrical and startup of the heater.

	Model	Voltage	kW	86°F (30°C) Ambient
				167°F (75°C) Insulated Wire Size Needed
C1N	C1N183/600D	600	18	10
	C1N253/600D	600	25	10
	C1N183/480D	480	18	10
	C1N253/480D	480	25	8
C2N	C2N363/600D	36	35	6
	C2N503/600D	50	49	4
	C2N363/480D	36	43	6
	C2N503/480D	50	60	3
CNA	CNA-363/600D	600	36	8
	CNA-543/600D	600	54	6
	CNA-633/600D	600	63	4
	CNA-723/600D	600	72	4
	CNA-363/480D	480	36	6
	CNA-543/480D	480	54	4
	CNA-633/480D	480	63	4
	CNA-723/480D	480	72	3

Cart Options

Carts feature push handle and forklift pockets to assist in moving heater from place to place. Carts are powder coated and constructed from welded steel tubing. All carts include 8" polyurethane casters with 2" wheel width and zinc plated forks.

Standard Cart: Standard cart package includes lockable heater enclosure, tamper resistant inspection cover over control panel to prevent tampering by unauthorized personnel, pigtail wire cable with plate and cable gland (shipped loose). Installer attaches heater to cart and provides final connections. The clear inspection cover is accessed only by using the special wrench shipped with the heater.

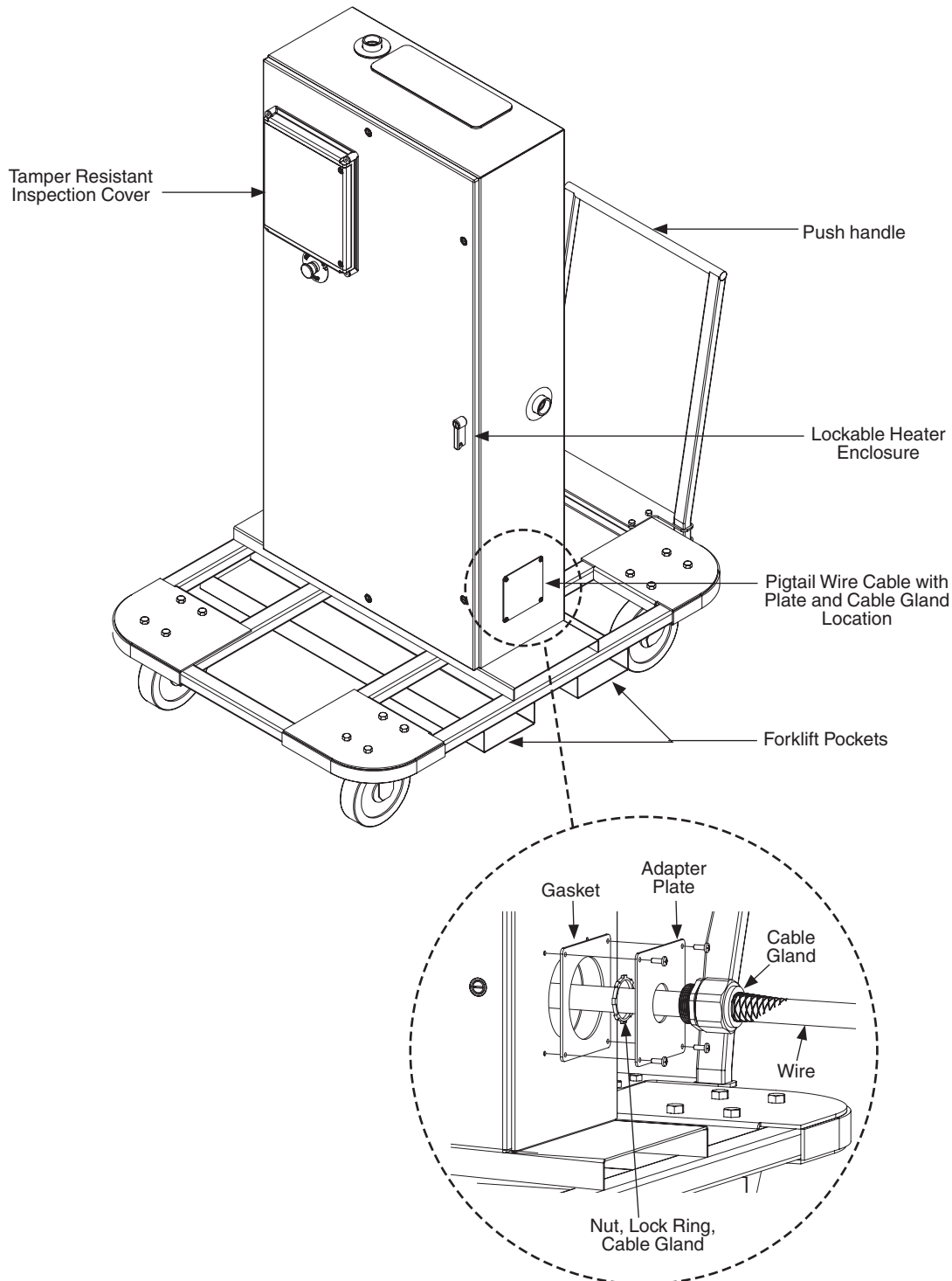

Cart Options

Deluxe Cart: Deluxe cart package includes lockable heater enclosure, tamper resistant inspection cover over control panel to prevent tampering by unauthorized personnel, Hubbell electrical connectors (shipped loose), welded tool box and truck brake to lock cart in place. Installer attaches heater to cart and provides final connections. The clear inspection cover is accessed only by using the special wrench shipped with the heater.

