



model VRK01EW.E

Mixing Valve Repair Kit

FEATURES & BENEFITS

OPTIONS

For more information, visit www.hawSCO.com or call (888) 640-4297.



SPECIFICATIONS

The Haws VRK01EW.A is a valve repair kit for the 9201EW mixing valve. This kit includes parts to repair the o-rings and thermostat.

APPLICATIONS

KIT INSTALLATION INSTRUCTIONS

VRK01EW.A: KIT, REPAIR, 9201EW, COMPLETE (REFER TO SHEET 2)

1. REFERRING TO SHEET 2, REMOVE THREADED VALVE COVER (5/8" FLAT).
2. REMOVE O-RING FROM COVER AND REPLACE WITH NEW O-RING FROM KIT.
3. REMOVE OVERLOAD ASSEMBLY FROM COVER BY PULLING STRAIGHT OUT, AND REPLACE WITH NEW OVERLOAD ASSEMBLY FROM KIT.
4. REMOVE PISTON/THERMOSTAT ASSEMBLY FROM VALVE BY PULLING STRAIGHT UP ON PISTON.
5. REMOVE THREE PISTON SPRINGS FROM VALVE FUNNEL.
6. REMOVE VALVE FUNNEL FROM VALVE BY PULLING STRAIGHT UP ON FUNNEL AND FUNNEL O-RING IF IT DOES NOT COME OUT WITH THE FUNNEL.
7. INSTALL NEW FUNNEL O-RING AND FUNNEL FROM KIT.
8. INSTALL 3 NEW PISTON SPRINGS FROM KIT INTO VALVE FUNNEL.
9. INSTALL NEW PISTON / THERMOSTAT ASSEMBLY INTO VALVE BODY AS SHOWN ON SHEET 2, BEING CAREFUL TO CLOCK THE PISTON SUCH THAT THE THREE FLATS UNDER THE PISTON SIT ON THE PISTON SPRINGS. THE PISTON SHOULD MOVE FREELY APPROXIMATELY 1/8" AGAINST THE SPRING PRESSURE.
10. THREAD THE EXISTING COVER WITH THE NEW O-RING (PER STEP 2) AND OVERLOAD ASSEMBLY (PER STEP 3) INTO THE VALVE. SNUG GENTLY AFTER COVER FLANGE CONTACTS VALVE BODY.
11. REFERRING TO SHEET 2, REMOVE THREADED CHECK STOP ASSEMBLIES FROM HOT AND COLD WATER CONNECTIONS (1" HEX). NOTE THAT HOT AND COLD CHECK STOPS ARE IDENTICAL.
12. THREAD NEW CHECK STOP ASSEMBLIES FROM KIT INTO VALVE BODY. GENTLY SNUG AFTER CHECK STOP HOUSING FLANGE CONTACTS VALVE BODY.
13. REFERRING TO SHEET 2, REMOVE THREADED COLD BYPASS COVER FROM VALVE BODY (3/4" HEX). REMOVE REMAINING PARTS OF THE COLD BYPASS ASSEMBLY (SPRING, POPPET WITH WASHER SEAT) FROM VALVE BODY.
14. THREAD NEW COLD BYPASS ASSEMBLY FROM KIT INTO VALVE BODY. GENTLY SNUG AFTER COVER FLANGE CONTACTS VALVE BODY.

VRK01EW.E: KIT, BASIC MAINT, 9201EW, T-STAT+O-RINGS

1. REFER TO EXPLODED VIEWS ON SHEET 2 AND DISASSEMBLY AND RE-ASSEMBLY INSTRUCTIONS ON THIS PAGE.
2. RECOMMEND ANY DRY O-RINGS BE LUBRICATED WITH FOOD GRADE SILICONE LUBRICANT, SUCH AS DOW CORNING 111 PRIOR TO INSTALLATION.
3. THERMOSTAT SHOULD BE INSTALLED SNUGLY, TAKING CARE NOT TO DAMAGE IT.

| | | | |
|---|--|---|-------------------------|
|  | | 1455 KLEPPE LANE SPARKS, NEVADA 89431 (775) 359-4712 FAX (775) 359-7424 E-MAIL: HAWS@HAWS.CO.COM WEBSITE: WWW.HAWS.CO.COM | |
| | | PART NUMBER 0510000955 | |
| ECN NO. REVISED PER BY: 5428 ECN: 5428 DP | MODEL(S) VRK01EW.A/E VALVE REPAIR KITS | REVISION 1 | |
| DRAWN: DP DATE: 06/26/19 CHK'D: FV | APPROVED: DP DATE: 06/27/19 | SCALE: N/A DRAWING TYPE: INSTALLATION | SIZE: A SHEET 1 OF 2 |

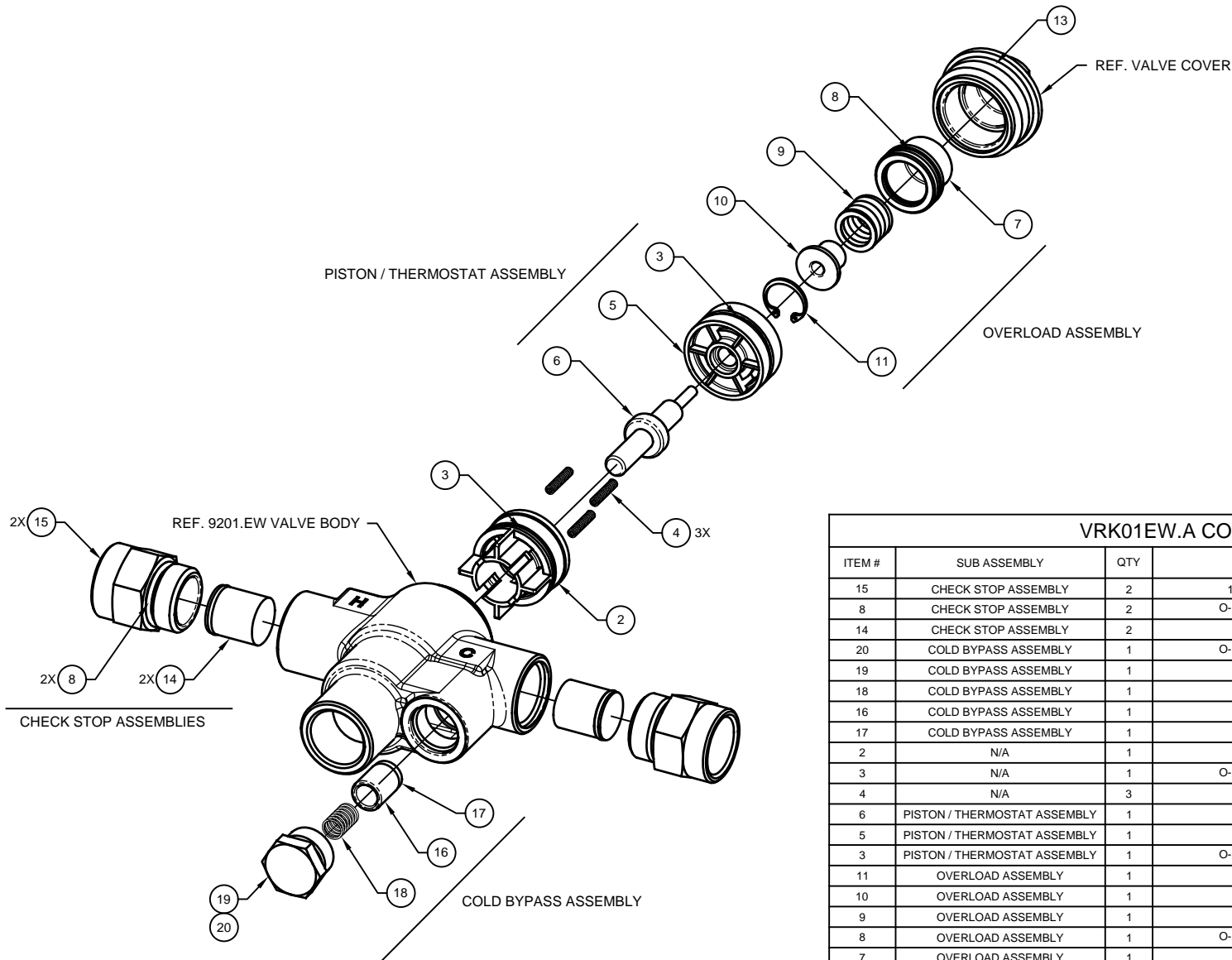

| VRK01EW.A COMPLETE REPAIR KIT | | | | |
|-------------------------------|------------------------------|-----|--------------------------------------|----------------------------|
| ITEM # | SUB ASSEMBLY | QTY | DESCRIPTION | VRK01EW.E BASIC MAINT. KIT |
| 15 | CHECK STOP ASSEMBLY | 2 | 1/2" NPT CHECK VALVE HOUSING | |
| 8 | CHECK STOP ASSEMBLY | 2 | O-RING DASH# 018 (.739 ID X .070 W) | INCLUDED |
| 14 | CHECK STOP ASSEMBLY | 2 | CHECK VALVE 16MM | |
| 20 | COLD BYPASS ASSEMBLY | 1 | O-RING DASH# 015 (.551 ID X .070 W) | INCLUDED |
| 19 | COLD BYPASS ASSEMBLY | 1 | COLD BYPASS COVER | |
| 18 | COLD BYPASS ASSEMBLY | 1 | COLD BYPASS SPRING SST | |
| 16 | COLD BYPASS ASSEMBLY | 1 | POPPET | |
| 17 | COLD BYPASS ASSEMBLY | 1 | SEAT WASHER EPDM | INCLUDED |
| 2 | N/A | 1 | FUNNEL, VALVE | |
| 3 | N/A | 1 | O-RING DASH# 022 (.989 ID X .070 W) | INCLUDED |
| 4 | N/A | 3 | PISTON SPRING SST | |
| 6 | PISTON / THERMOSTAT ASSEMBLY | 1 | MAIN THERMOSTAT 60-90 | INCLUDED |
| 5 | PISTON / THERMOSTAT ASSEMBLY | 1 | PISTON | |
| 3 | PISTON / THERMOSTAT ASSEMBLY | 1 | O-RING DASH# 022 (.989 ID X .070 W) | INCLUDED |
| 11 | OVERLOAD ASSEMBLY | 1 | RETAINING RING | |
| 10 | OVERLOAD ASSEMBLY | 1 | OVERLOAD INSERT | |
| 9 | OVERLOAD ASSEMBLY | 1 | OVERLOAD SPRING SST | |
| 8 | OVERLOAD ASSEMBLY | 1 | O-RING DASH# 018 (.739 ID X .070 W) | INCLUDED |
| 7 | OVERLOAD ASSEMBLY | 1 | OVERLOAD HOUSING | |
| 13 | N/A | 1 | O-RING DASH# 122 (1.112 ID X .103 W) | INCLUDED |

VRK01EW.A COMPLETE REPAIR KIT SHOWN ON THIS SHEET



Haws[®]

1455 KLEPPE LANE
SPARKS, NEVADA 89431
(775) 359-4712 FAX (775) 359-7424
E-MAIL: HAWS@HAWSCO.COM
WEBSITE: WWW.HAWSCO.COM

| | | | | |
|-----------------|--------------------------|--------------|--|--|
| ECN NO: 5428 | REVISED PER ECN: 5428 | BY: DP | MODEL(S) | |
| DRAWN: DP | DATE: 06/26/19 | CHKD.: FV | VRK01EW.A/E VALVE REPAIR KITS | |
| APPROVED: DP | DATE: 06/27/19 | SCALE: N/A | DRAWING TYPE: INSTALLATION | PART NUMBER 0510000955 REVISION 1 |
| | | | SIZE: A | SHEET 2 OF 2 |