

Date:

Project Name:

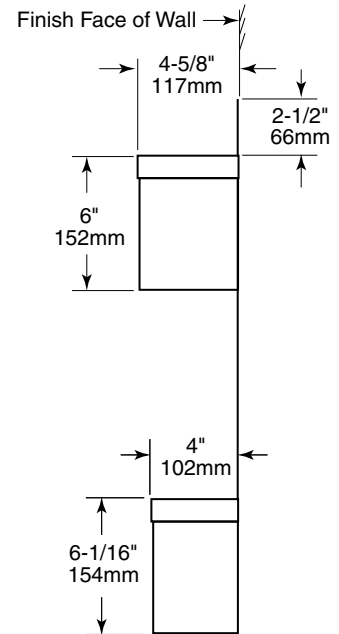
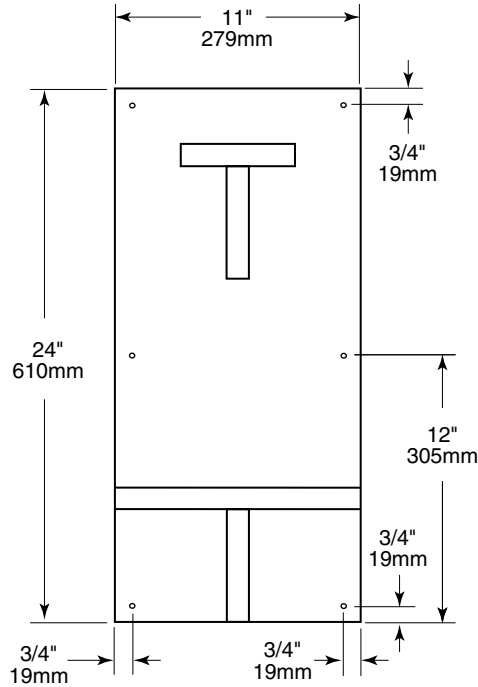
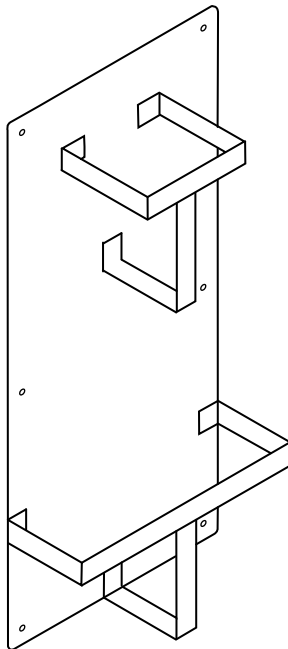

CONSTRUCTION:

Unit fabricated of 18-gauge (1.2mm) and 16-gauge (1.5mm) type 304 stainless steel with exposed surfaces having a satin-finish. All welded construction.

INSTALLATION:

Unit is secured to wall with six (6) #10 x 1-1/2" (38mm) Philips pan head machine screws. Wood blocking is preferable behind all wall surfaces.

NOTE:

If wood blocking is not available, the following optional fasteners are suggested:

- Tile/Masonry - Plastic or lead anchors
- Plaster/Drywall - Toggle bolts

Surface-Mounted Bed Pan and Urinal Holder shall be Model BP-1 of Gamco Commercial Restroom Accessories, A Division of Bobrick, One Gamco Place, Durant, OK