



LC800 Patient Care Unit, 47", Fixed Water Closet

- Combination Lavatory Closet Module
- China or Epoxy Coated Stainless Steel Toilet
- Meets Low Flow Flushing Requirements
- Built-In Bedpan Washer
- Stainless Steel Toe Kicks

Specifications—Standard Equipment

Cabinet

Frame is stainless steel; cabinet exterior is ¾" MDF with laminate finish in Wilsonart #1531-60 Light Beige. Interior finishes are laminate and satin finish stainless steel. Doors have rounded corners to enhance patient safety. Toilet tissue holder is conveniently located inside the cabinet door.

Countertop

Standard finish for MDF/laminate countertop is Wilsonart #4633 Natural Nebula. Other countertop selections include other laminates, Terreon®, a densified solid surface material composed of bio-based resin or Terreon®RE, a densified solid surface material composed of a bio-based resin and preconsumer recycled granules. Terreon and TerreonRE are resistant to chemicals, stains, burns and impact. Surface damage can be easily repaired with everyday cleansers or fine grit abrasives. Terreon and TerreonRE are certified by Home Innovation Lab to meet CSA B45.5/IAPMO Z124. Terreon and TerreonRE are GREENGUARD® certified as low-emitting materials.

Lavatory

Lavatory is 14 gauge stainless steel with factory-installed caulking. Measures 14½" x 9½" x 5" deep. Optional Terreon countertop features an integral 16¾" x 9½" x 8" deep double step bowl with IV drip ledge. Traps and stops complying with local codes to be furnished by plumbing contractor.

Toilet

Available in left- or right-side toilet configurations. Toilet is available in floor or wall mount with a top spud inlet supply. Toilet is available in siphon jet elongated white china with bedpan lugs. Stainless steel toilet is constructed entirely of heavy gauge stainless steel and will support a 5,000 lb. static load. Siphon jet type with elongated bowl, integral flushing rim, and remote-actuated hydraulic flushing system with push button. 25 PSI minimum is required for flushing. White seat with cover has self-sustaining hinge. Toilet assembly meets ANSI/ASME A112.19.2.

 1.6 gpf is not available for use in California per California Energy Commission 20 CCR T. 20, Div. 2, §1601-1609.

Check Your Surroundings

Certain factors, such as intense direct sunlight, other infrared devices, or other site conditions may interfere with the activation of infrared faucets. Contact your local Bradley representative to discuss any application concerns.

cUPC Approval

Patient Care LC800 is Uniform Plumbing Code (UPC), International Plumbing Code (IPC) and National Plumbing Code of Canada (NPC) approved through the International Association of Plumbing and Mechanical Officials (IAPMO). Manufactured in compliance with IGC 156-2009, CSA B45 Series-2002 (R08) & ASME A112.18.1-2005/CSA B125.1-2005.

Verify all rough-in dimensions prior to installation.

Consult local and national codes. Conformity and compliance to local and national codes is the responsibility of the installer.

Page 1 of 4

6/8/2017

This information is subject to change without notice.

Bradley_PatientCare_LC800

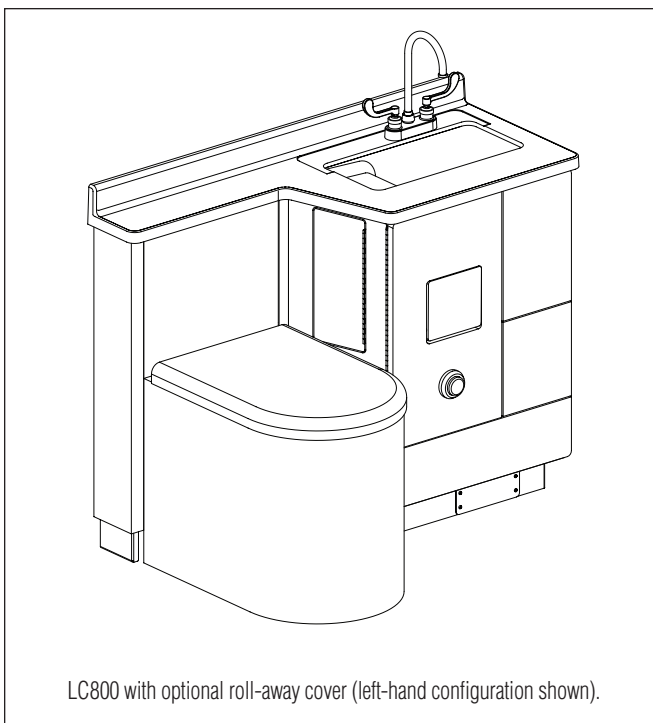

LC800 with optional roll-away cover (left-hand configuration shown).

 Standard product selections contained within this document are third party **CERTIFIED** to NSF/ANSI 372 meeting the Lead-Free content requirement. Any product configured with custom options will be **COMPLIANT** with NSF/ANSI 372 meeting the Lead-Free content requirement.

Office of Statewide Health Planning and Development

ANCHORAGE PRE-APPROVAL

Equipment Type: LavCare 800 Series

Patient Care Module 47" Fixed Water Closet



© 2017 Bradley
P.O. Box 309, Menomonee Falls, WI 53052-0309
800 BRADLEY (800 272 3539) +1 262 251 6000
bradleycorp.com



LC800

Patient Care Unit, 47", Fixed Water Closet

LEFT HAND VERSION

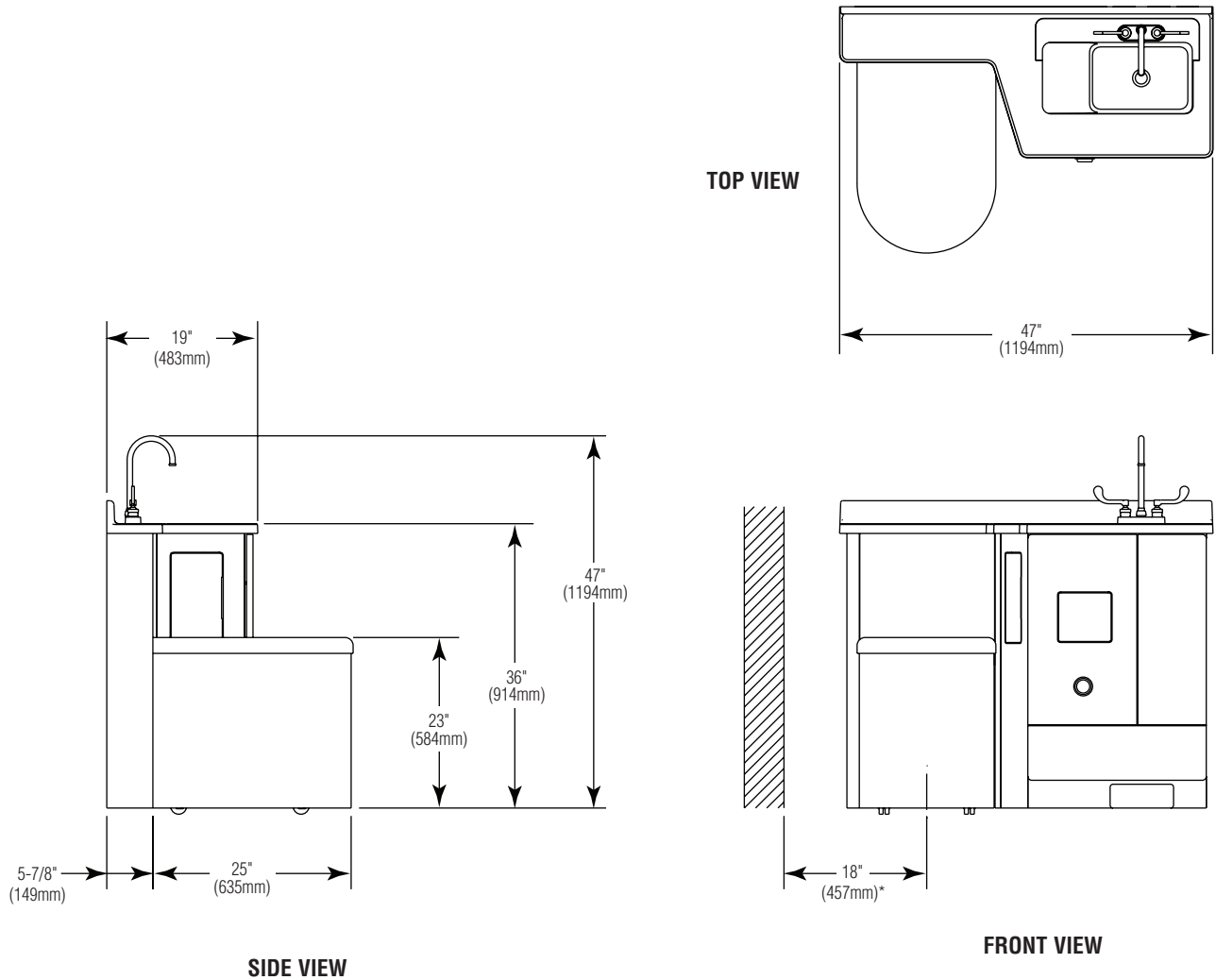

* 18" (457mm) minimum clearance between sidewall & centerline of watercloset required to allow for proper leg clearance.

Bradley Corporation reserves the right to make changes in design and material without formal notice, and without incurring obligation. Verify all rough-in dimensions prior to installation.

Verify all rough-in dimensions prior to installation.

Consult local and national codes. Conformity and compliance to local and national codes is the responsibility of the installer.

Page 2 of 4 6/8/2017

This information is subject to change without notice.

Bradley_PatientCare_LC800

© 2017 Bradley
P.O. Box 309, Menomonee Falls, WI 53052-0309
800 BRADLEY (800 272 3539) +1 262 251 6000
bradleycorp.com



LC800

Patient Care Unit, 47", Fixed Water Closet

RIGHT-HAND VERSION

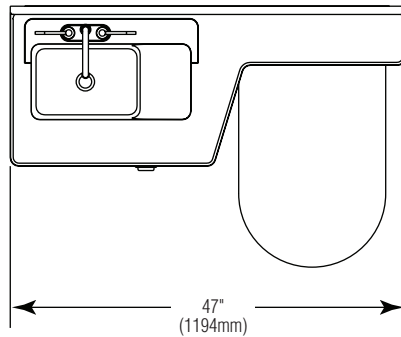

TOP VIEW

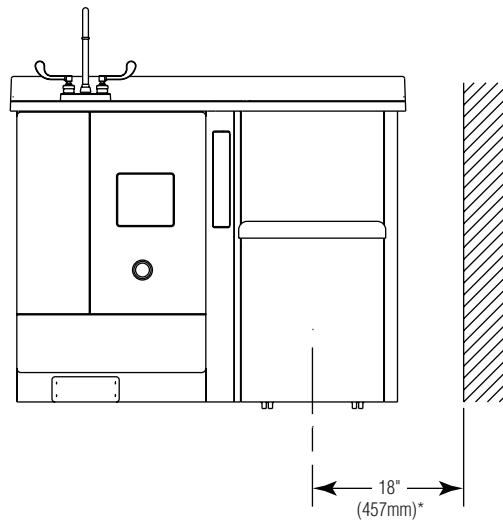

FRONT VIEW

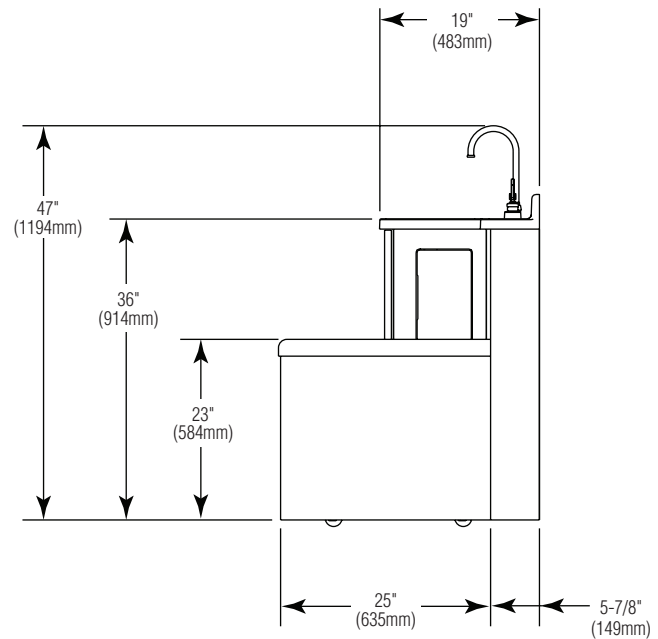

SIDE VIEW

* 18" (457mm) minimum clearance between sidewall & centerline of watercloset required to allow for proper leg clearance.

Verify all rough-in dimensions prior to installation.

Consult local and national codes. Conformity and compliance to local and national codes is the responsibility of the installer.

Page 3 of 4 6/8/2017

This information is subject to change without notice.



Bradley_PatientCare_LC800

© 2017 Bradley
P.O. Box 309, Menomonee Falls, WI 53052-0309
800 BRADLEY (800 272 3539) +1 262 251 6000
bradleycorp.com

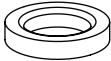
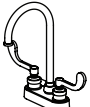

LC800

Patient Care Unit, 47", Fixed Water Closet

Model	Description
<input type="checkbox"/> LC800	47" Patient Care Unit, Pivot Water Closet, Bedpan Washer
Standard Selections (MUST select one from each category)	
Water Closet Location (select one): <input type="checkbox"/> LEFT Left-Side <input type="checkbox"/> RIGHT Right-Side	
	
Water Closet Material: <input type="checkbox"/> STAINSS Stainless Steel <input type="checkbox"/> CHINA China	
Mounting (select one): <input type="checkbox"/> FTD Floor <input type="checkbox"/> WTD Wall	
Water Closet Waste Connection (select one): <input type="checkbox"/> GSKT Neoprene Gasket	
	
Cabinet Color (select one): <input type="checkbox"/> SCC Wilsonart #1531-60 Light Beige Laminate (Standard) <input type="checkbox"/> SPCC Specify Formica, Wilsonart or Nevamar Brand Laminates Color: _____	
Lavatory Valve (select one): <input type="checkbox"/> WB Deck-Mounted Faucet/Wristblade Handles <input type="checkbox"/> FP Deck-Mounted Spout/Foot Pedal Control <input type="checkbox"/> IR-AC Infrared Gooseneck Faucet* <input type="checkbox"/> IR-DC Infrared Gooseneck Faucet, Battery Operation*	
  	
Mixing Valve Selections (for IR Lavatory Valves): <input type="checkbox"/> TMA TMA Navigator® Thermostatic Mixing Valve	
Bedpan Washer: <input type="checkbox"/> BWVC Bedpan Washer w/ Volume Control Valve† <input type="checkbox"/> BWFC Bedpan Washer w/ Foot Control Valve†	
Dialysis Box: <input type="checkbox"/> DB1 Single Valve Dialysis Box <input type="checkbox"/> DB2 Dual Valve Dialysis Box <input type="checkbox"/> SB Storage Box	

Standard Selections (Must select one from each category)

Countertop Color

- ☐ **STC** Wilsonart #4633 Natural Nebula laminate (standard)
☐ **SPTC** Specify Formica, Wilsonart or Nevamar Brand laminates
Color: _____
☐ **TERR** Terreon Countertop (must select top & bowl)

Top

Standard Colors

- | | |
|---|--|
| <input type="checkbox"/> ALP-WHT Alpine White | <input type="checkbox"/> LANNON Lannonstone |
| <input type="checkbox"/> AVALANCHE Avalanche† | <input type="checkbox"/> LONDON London Gray |
| <input type="checkbox"/> BONE Mesa Bone | <input type="checkbox"/> MOONSTONE Moonstone† |
| <input type="checkbox"/> CHAR Charcoal Gray | <input type="checkbox"/> O-TAUPE Organic Taupe |
| <input type="checkbox"/> COBBLE Cobblestone | <input type="checkbox"/> PEBBLE Pebble Beach |
| <input type="checkbox"/> DRIFT Driftwood† | <input type="checkbox"/> PEP-WHT Peppered White |
| <input type="checkbox"/> DS-WHT Designer White | <input type="checkbox"/> POLAR Polar Ice† |
| <input type="checkbox"/> DUNE Sand Dune† | <input type="checkbox"/> SAND Sandtrap |
| <input type="checkbox"/> E-GRAY Empire Gray | <input type="checkbox"/> S-CREEK Stone Creek |
| <input type="checkbox"/> GLACIER Glacier | <input type="checkbox"/> S-MIST Silver Mist |
| <input type="checkbox"/> GRAPH Graphite | <input type="checkbox"/> WHT-SAND White Sand |

Designer Colors (available at an additional charge)

- | | |
|--|--|
| <input type="checkbox"/> ARC-CHIP Arctic Chip | <input type="checkbox"/> RIVER Riverstone |
| <input type="checkbox"/> COFFEE Coffee Bean | |

TerreonRE Colors (available at an additional charge)

- | | |
|---|---|
| <input type="checkbox"/> BIRCH-BARK Birch Bark | <input type="checkbox"/> MOONDUST Moondust |
| <input type="checkbox"/> DUSK Dusk | <input type="checkbox"/> OAT Oat |

Bowl

- | | |
|---|---|
| <input type="checkbox"/> SAME | <input type="checkbox"/> LONDON London Gray |
| <input type="checkbox"/> ALP-WHT Alpine White | <input type="checkbox"/> O-TAUPE Organic Taupe |
| <input type="checkbox"/> BONE Mesa Bone | |
| <input type="checkbox"/> DS-WHT Designer White | |

- ☐ **NO-TOP** Less Countertop and Lavatory

Countertop Backsplash

- ☐ **BSO** One Wall - Back Side Only (standard)
☐ **BSRS** Two Walls - Back and Right Side
☐ **BSLS** Two Walls - Back and Left Side
☐ **BSBS** Three Walls - Back, Right & Left Sides from Alcove

Optional Selections

- ☐ **STRC** Roll-Away Water Closet Cover/Exam Stool Wilsonart #1531-60 Light Beige (standard)
☐ **SPRC** Specify Formica, Wilsonart or Nevamar Brand Laminates
☒ Not available with BWFC option. Roll-away interferes with foot pedal.
☐ **SGB** Swing-Down Grab Bar - 35" Long
☐ **WGB** Wall Grab Bar - 48" Long

* Infrared faucets not available with **PS** countertop selection.

†This color contains large, randomly distributed chips.

‡ Backflow preventer required with bedpan washer selection. It is automatically added when bedpan washer is selected.

- ☒ All Patient Care Units are non-cancelable and non-returnable because they are made to exact specifications for each order.
- ☒ Bradley Corporation reserves the right to make changes in design and material without formal notice, and without incurring obligation.

Verify all rough-in dimensions prior to installation.

Consult local and national codes. Conformity and compliance to local and national codes is the responsibility of the installer.

Page 4 of 4

6/8/2017

This information is subject to change without notice.

Bradley_PatientCare_LC800

- ☒ Once you have determined your configuration, please contact your Bradley Representative for rough-in information.

© 2017 Bradley
P.O. Box 309, Menomonee Falls, WI 53052-0309
800 BRADLEY (800 272 3539) +1 262 251 6000
bradleycorp.com